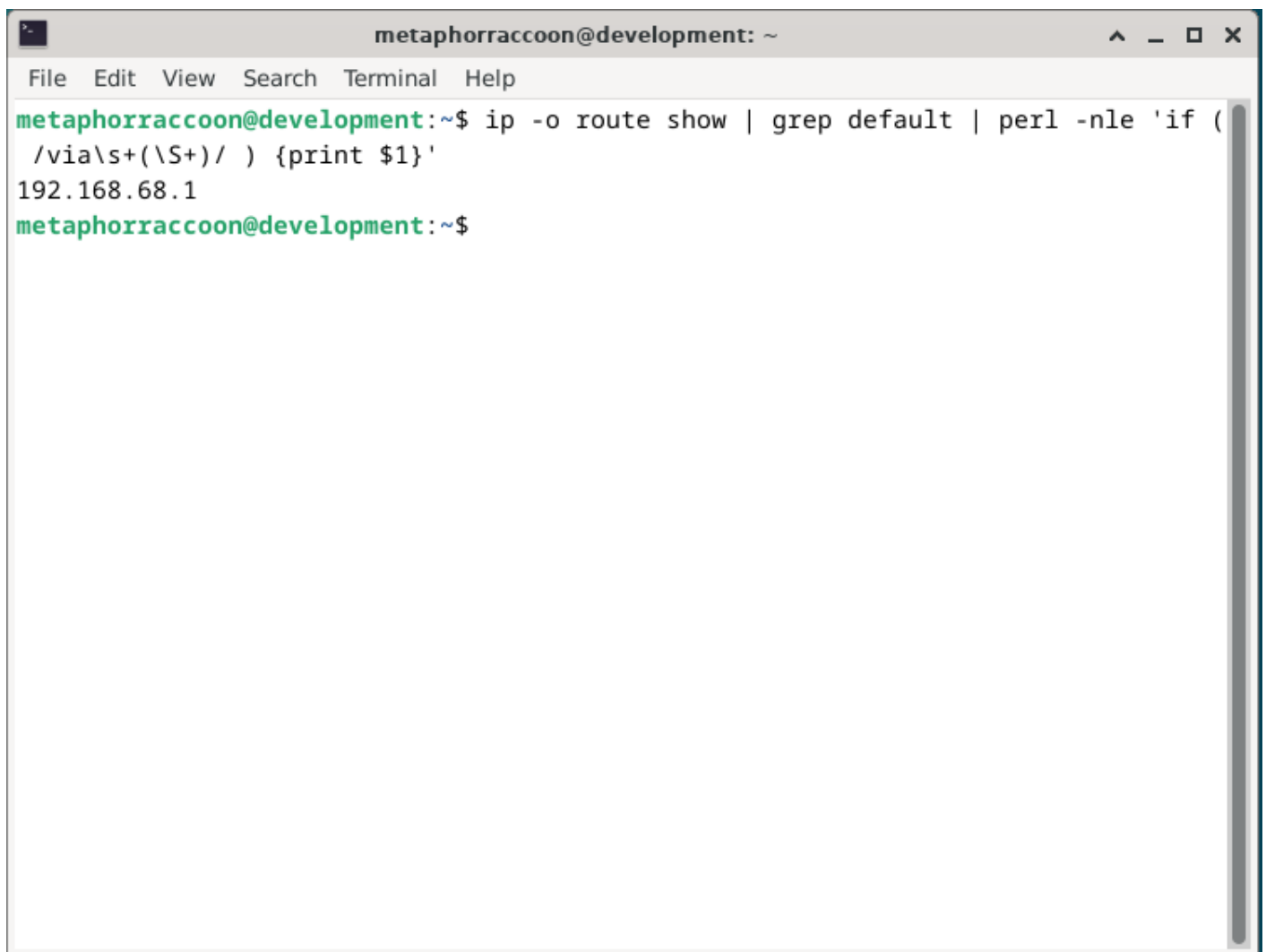

Accessing our Router Dashboard

Connecting our web server to the internet will require gaining access to our router's administrative dashboard. We can find our routers address by using the command:

```
ip -o route show | grep default | perl -nle 'if ( /via\s+(\S+)/ ) {print $1}'
```

A terminal window titled 'metaphorrraccoon@development: ~' with a menu bar (File, Edit, View, Search, Terminal, Help). The prompt is 'metaphorrraccoon@development:~\$'. The command 'ip -o route show | grep default | perl -nle 'if (/via\s+(\S+)/) {print \$1}'' is entered. The output '192.168.68.1' is displayed. The prompt returns to 'metaphorrraccoon@development:~\$'.

```
metaphorrraccoon@development:~$ ip -o route show | grep default | perl -nle 'if ( /via\s+(\S+)/ ) {print $1}'
192.168.68.1
metaphorrraccoon@development:~$
```

Going to our web browser, we can enter the IP address returned by our command:

```
192.168.68.1
```

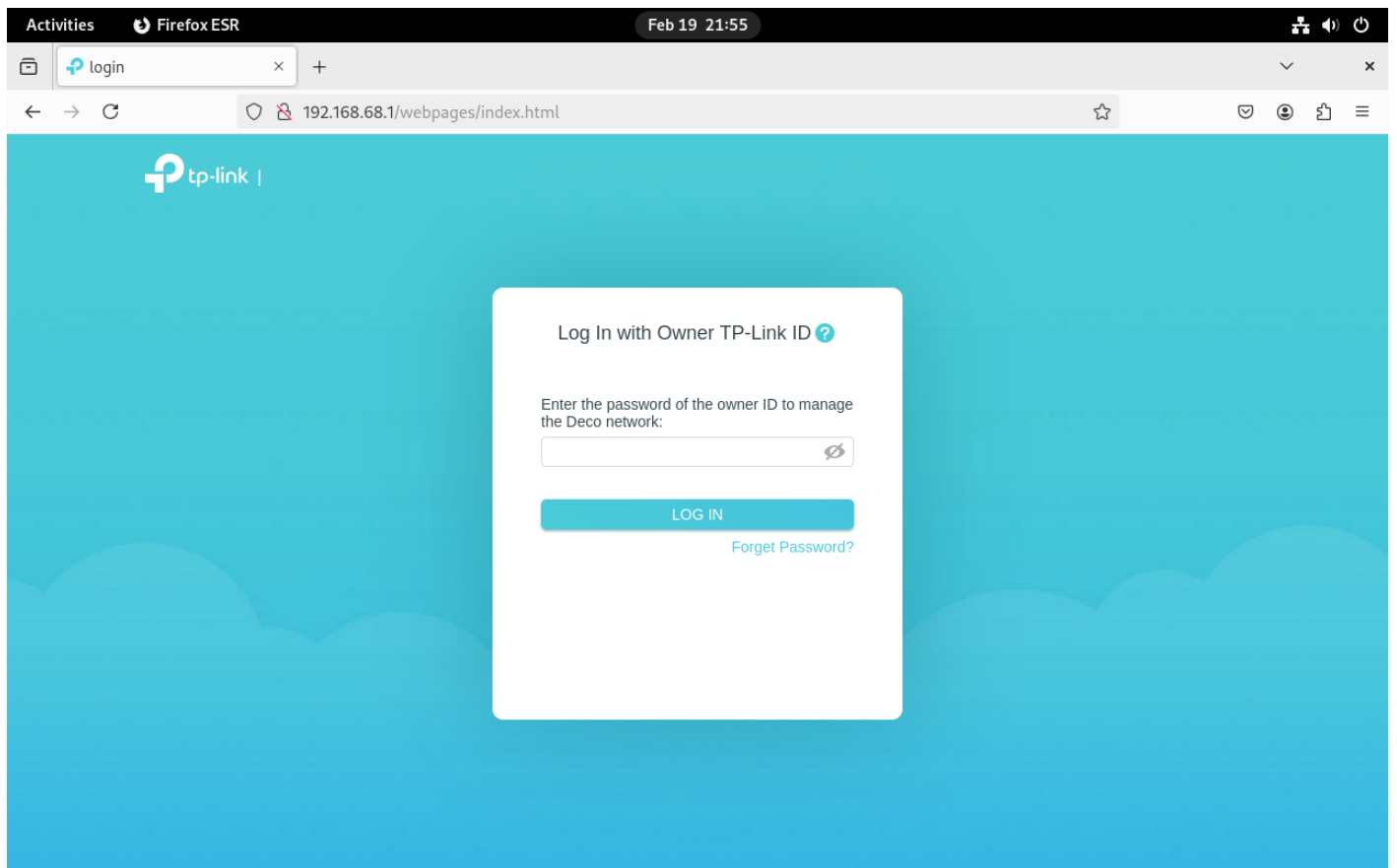

Some routers may require an app to access all configuration settings.

Sign in. Default username and password.

Revision #5

Created 17 February 2025 01:47:19 by metaphorraccoon

Updated 21 February 2025 09:16:10 by metaphorraccoon